

Temperature Sensors for Surface Measurement **TTJE-306, TTKE-306**

Specification

Temperature range / sensing element

-40÷400°C **K, J** class 2

Sheath

- material: stainless steel 1.4541
- ring dimensions:
 $d_{\min}=4$ mm, $D=10\div 25$ mm, $L_{\min}=4$ mm

Lead wire

- thermocouple stranded wire: $2 \times 0,22$ mm²
 fiberglass insulation, metallic overbraid for $L \geq 5$ mm
- thermocouple solid wire: $2 \times 0,2$ mm²
 fiberglass insulation, metallic overbraid for $L < 5$ mm
- length L_p [m]: 1,5 (standard)

Options

- other lead wire insulation types acc. to requirements:
 operating temperature of silicone insulation – up to 180°C
 operating temperature of teflon insulation – up to 200°C

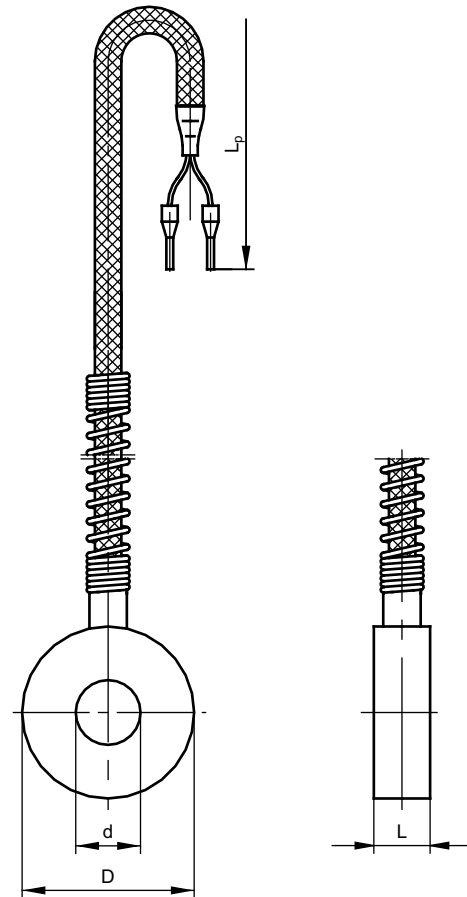

Ordering code

Temperature sensor



- Thermocouple Fe-CuNi: **J** _____
- Thermocouple NiCr-NiAl: **K** _____
- Ring dimensions d/DxL: **5/10x5** or other* _____
- Thermocouple class: **1, 2** _____
- Lead wire length L_p [m]: **1,5** or other* _____
- *Other parameters acc. to requirements

Ordering example:

TTKE-306-4,5/8x5-2-2 m single sensor with thermocouple NiCr-NiAl /K/, class 2, ring dimensions $d=4,5$ mm, $D=8$ mm, $L=5$ mm, lead wire length $L_p=2$ m