

Temperature Sensors with Ceramic Protection Tubes **TTSC-22, TTRC-22, TTBC-22, TTKC-22**

Specification

Temperature range / sensing element

-40÷1200°C	K	class 2
0÷1600°C	S, R	class 2
600÷1600°C	B	class 3

Sheath

- holding tube material: stainless steel 1.4841 \varnothing 22 mm
- ceramic tube: mullite 610 or corundum 799, \varnothing 15x2,5 mm
- length L [mm]: 300÷2000

Connection head

- AA, IP53, -40÷100 °C

Options

- thermocouple S, R, K class 1, B class 2
- with transmitter 4÷20 mA in connection head DAW

Additional accessories

- temperature transmitters – pp. 162÷174
- compensation cables – p. 145
- sensor mounting fittings: UZ-11, UZ-21 – p. 156

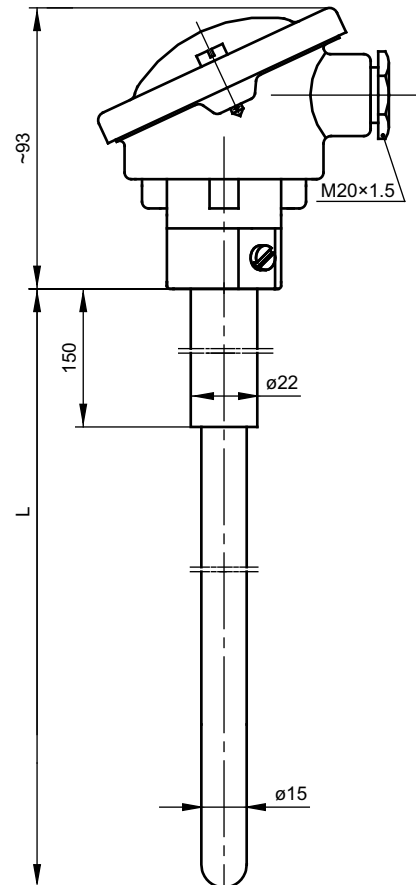

Sheath material	Wire diameter [mm]	Thermocouple type	Max. operating temp.
mullite 610	0,35	R, S	1200°C
mullite 610	0,5	R, S	1400°C
corundum 799	0,35	R, S	1500°C
corundum 799	0,5	R, S	1600°C
corundum 799	0,35	B	1600°C
corundum 799	0,5	B	1600°C
mullite 610	2	K	1200°C

Ordering code

Temperature sensor

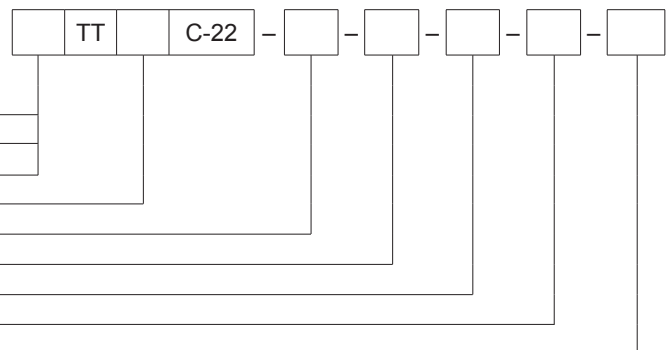

Single: **no designation**

Double: **2**

With transmitter: **AP**

Thermocouple: **B, K, R, S**

Sheath material: **610, 799**

Sheath length L [mm]: **500, 710, 1000, 1400** or other*

Thermocouple class: (**1, 2** for K, S, R); (**2, 3** for B)

Platinum wire diameter d [mm]: **0,35** or **0,5**

Transmitter type – temperature range: **Tx-(0÷1200)°C***

*Other parameters acc. to requirements

Ordering example:

TTSC-22-799-1000-2-0,35 single sensor with thermocouple PtRh10-Pt /S/, class 2, platinum wire diameter 0,35 mm, ceramic sheath corundum 799, diameter 15 mm, length L=1000 mm

2TTBC-22-799-800-2-0,5 double sensor with thermocouple PtRh30-PtRh6 /B/, class 2, platinum wire diameter 0,5 mm, ceramic sheath corundum 799, diameter 15 mm, length L=800 mm